



£220,000 Freehold

47 BLUEBANK VIEW | NEW WHITTINGTON | CHESTERFIELD | S43 2DW

BuckleyBrown
ESTATE AGENTS

"The property offers a balanced combination of space and practicality, with accommodation arranged in a way that maximises usability and provides a comfortable living environment overall."

- Jasmine, Valuer





Rare Opportunity to Create Your Ideal Home

A three-bedroom detached property offering excellent potential and versatile living accommodation

Offering spacious and versatile accommodation, ideally suited to a range of buyers. The home provides a solid foundation with well-proportioned rooms throughout, presenting an excellent opportunity for modernisation and personalisation. With its detached position and generous layout, the property also benefits from additional privacy and flexibility, making it a great option for those looking to create a home tailored to their own taste and requirements.

Step Inside

Inside the home is in good condition, vacant, and ready for you to move straight in and make it your own.

The ground floor comprises a welcoming entrance hall, leading into a spacious open-plan living and dining room, featuring French doors opening onto the rear garden. There is also a well-appointed kitchen, offering a practical and functional layout for everyday living.

To the first floor, the property offers three well-proportioned bedrooms, providing comfortable accommodation for a range of buyers, along with a family bathroom serving this level.

Externally, the property benefits from a private driveway providing off-street parking, a single garage, and a low-maintenance rear courtyard with a patio area, ideal for outdoor seating or entertaining.

Life in New Whittington

New Whittington is a well-established residential village located on the outskirts of Chesterfield in Derbyshire, offering a convenient and community-focused setting that appeals to a

wide range of buyers. Combining local amenities with easy access to nearby towns and countryside, it provides a balanced lifestyle ideal for families, professionals and first-time buyers alike.

The village benefits from a strong local identity, with everyday amenities including shops, schools, pubs and healthcare facilities all within easy reach. Its close-knit community feel makes it particularly attractive to those seeking a more relaxed pace of life while still remaining well connected to larger urban centres.

Surrounded by open countryside and green spaces, New Whittington is well placed for those who enjoy outdoor pursuits. Nearby walking routes, parks and scenic areas provide ample opportunity for recreation, while the surrounding Derbyshire landscape offers even more to explore just a short distance away.

Despite its village setting, New Whittington is well connected for commuters. Chesterfield town centre is just a short drive away, offering a wider range of retail, leisure and dining options, while excellent road links via the A61 and nearby access to the M1 make travel to Sheffield, Derby and beyond straightforward.

Overall, New Whittington offers a practical and appealing location, blending community living with convenience and accessibility. Its range of amenities, transport links and proximity to both countryside and larger towns make it a popular choice for a variety of buyers.



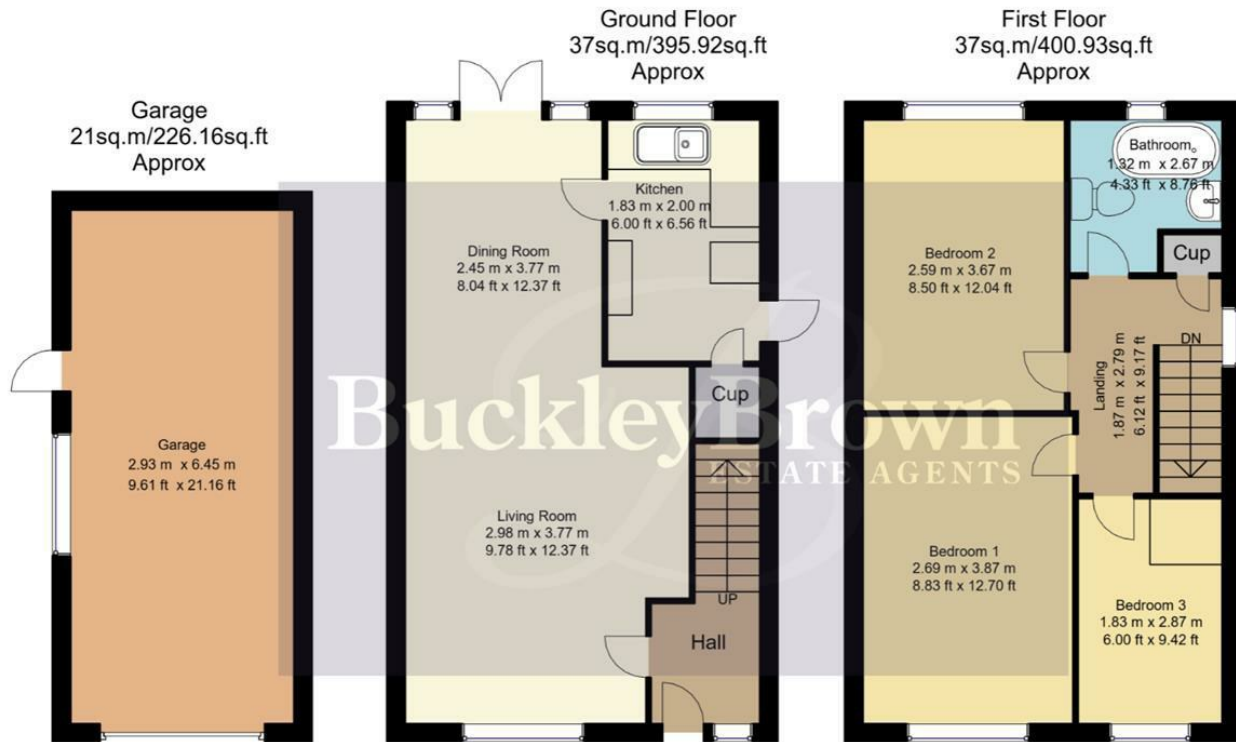

Whilst every attempt has been made to ensure the accuracy of the floor plan contained here, no responsibility is taken for incorrect measurements of doors, windows, appliances and room or any error, omission or misstatement. Exterior and interior walls are drawn to scale based on interior measurements. Any figure given is for initial guidance only and should not be relied on as basis of valuation. These plans are for marketing purposes only and should be used as such by any prospective purchase. Specially no guarantee should not be relied on as a basis of valuation. These plans are for marketing purposes only and should be used as such by any prospective purchase. Specially no guarantee is given on the total square footage of the property if quoted on this plan.
CC Ltd ©2018

IMPORTANT: we would like to inform prospective purchasers that these sales particulars have been prepared as a general guide only. A detailed survey has not been carried out, nor the services, appliances and fittings tested. Room sizes should not be relied upon for furnishing purposes and are approximate. If floor plans are included, they are for guidance only and illustration purposes only and may not be to scale. If there are any important matters likely to affect your decision to buy, please contact us before viewing the property.

Energy Efficiency Rating		Current	Potential
Very energy efficient - lower running costs			
(92 plus) A			
(81-91) B			
(69-80) C			
(55-68) D		68	77
(39-54) E			
(21-38) F			
(1-20) G			
Not energy efficient - higher running costs			
England & Wales		EU Directive 2002/91/EC	

47 BLUEBANK VIEW
NEW WHITTINGTON
CHESTERFIELD
S43 2DW



BuckleyBrown Estate Agents

55 - 57 Leeming Street | Mansfield | Nottinghamshire | NG18 1ND
23 High Street | Edwinstowe | Nottinghamshire | NG21 9QP
1 Market Place | Bolsover | Chesterfield | S44 6PN
www.buckleybrown.co.uk

t: 01623 633 633
t: 01623 633 633
t: 01246 605121



IMPORTANT: we would like to inform prospective purchasers that these sales particulars have been prepared as a general guide only. A detailed survey has not been carried out, nor the services, appliances and fittings tested. Room sizes should not be relied upon for furnishing purposes and are approximate. If floor plans are included, they are for guidance only and illustration purposes only and may not be to scale. If there are any important matters likely to affect your decision to buy, please contact us before viewing the property.